

DAPH Hygienic Seal DN 38

Fully stainless steel seal with flush diaphragm

Fast fitting and removal

Sterilisation and cleaning in place

Fluid temperature up to 150°C depending on pressure

3-A approval

Diaphragm surface finish $\leq 0.8 \mu\text{m}$

Seal DAPH can be fitted with MEX2, MEX3 and MEX35 pressure gauges on the Bourdon-Haenni in-line pipe.

This seal has been designed for processes requiring rigorously clean conditions using cleaning and sterilising in place systems (CIP, SIP). It is intended for the food processing and pharmaceutical industries.

The pressure is transmitted to the measuring instrument via a neutral transmitting fluid which complies with FDA recommendations.

An O-ring guarantees tightness between the seal and the in-line connection.



Specifications

Measurement range

| | | |
|---------------------|--|--|
| Fluid temperature | $-10 \leq T \leq +100^{\circ}\text{C}$ | $-10 \leq T \leq +150^{\circ}\text{C}$ |
| Ambient temperature | $-10 \leq T \leq +50^{\circ}\text{C}$ | $-10 \leq T \leq +70^{\circ}\text{C}$ |
| Measurement range | 0...+4 bar to 0...+25 bar | 0...+6 bar to 0...+25 bar |
| | -1...+3 bar to -1...+24 bar | -1...+5 bar to -1...+24 bar |

Material Stainless steel 1.4404 (316L)

Transmitting liquid LRS1, -15 ... +150°C

Accuracy class of pressure gauges at 20°C MEX2 (ø50mm) - MEX3 (ø63 mm): class 1.6
MEX35* (ø100 mm): class 1.6

Weight 0.350 kg

*Note

The MEX35 is a fully stainless steel, class 1.6, DN 100 pressure gauge specially developed for use with a seal within the measurement ranges given above. Type D and G1/2 connection only.



Dimensions

[mm]

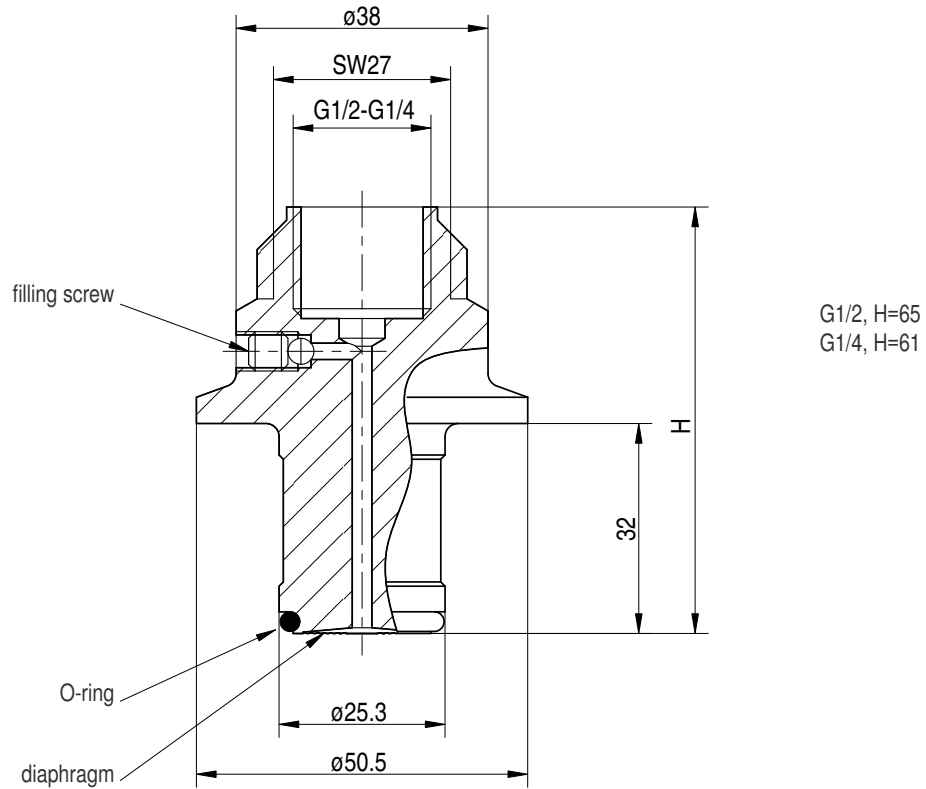

Photo of application

MEX35 ($\varnothing 100$ mm) used with seal DAPH fitted on the Bourdon-Haenni in-line pipe.



DAPH ordering information

| | | DAPH xx |
|----------------------------------|---------------|---------|
| Model | 1'...4' digit | |
| DN 38 hygienic seal | | DAPH |
| Pressure gauge connection | 5'...6' digit | |
| G1/4 female | | 0H |
| G1/2 female | | 0L |

* DN 38 Clamp collar: uncoded option